

RESTROOMS

- 1 - Rework salad bar/serve area, including half-height walls for power from ceiling.
- 2 - New 8 1/2" dish drop area. Also add 2 Katch-All silver savers to prevent flatware from falling into trash cans.
- 3 - Remove existing double sided sneeze guards and install new single sided pass shelf.
- 4 - Remove wall behind existing table (Item #38) to allow more room behind grill area and also provide easy pass thru from kitchen.
- 5 - Remove Item 34, existing hot cabinet (is currently not working), reduce back wall 24" to open up walkway at dishroom.

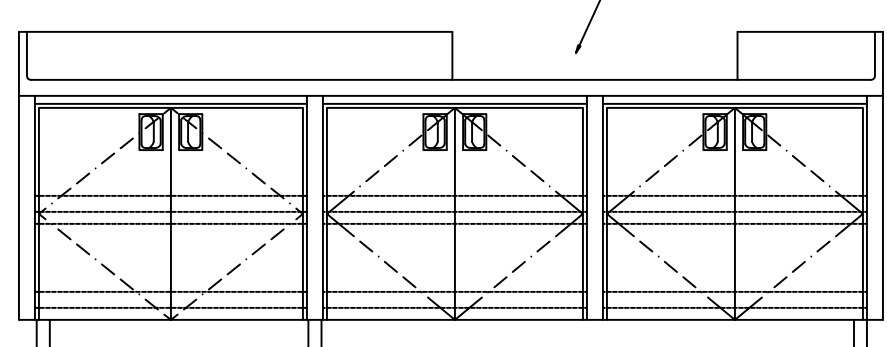
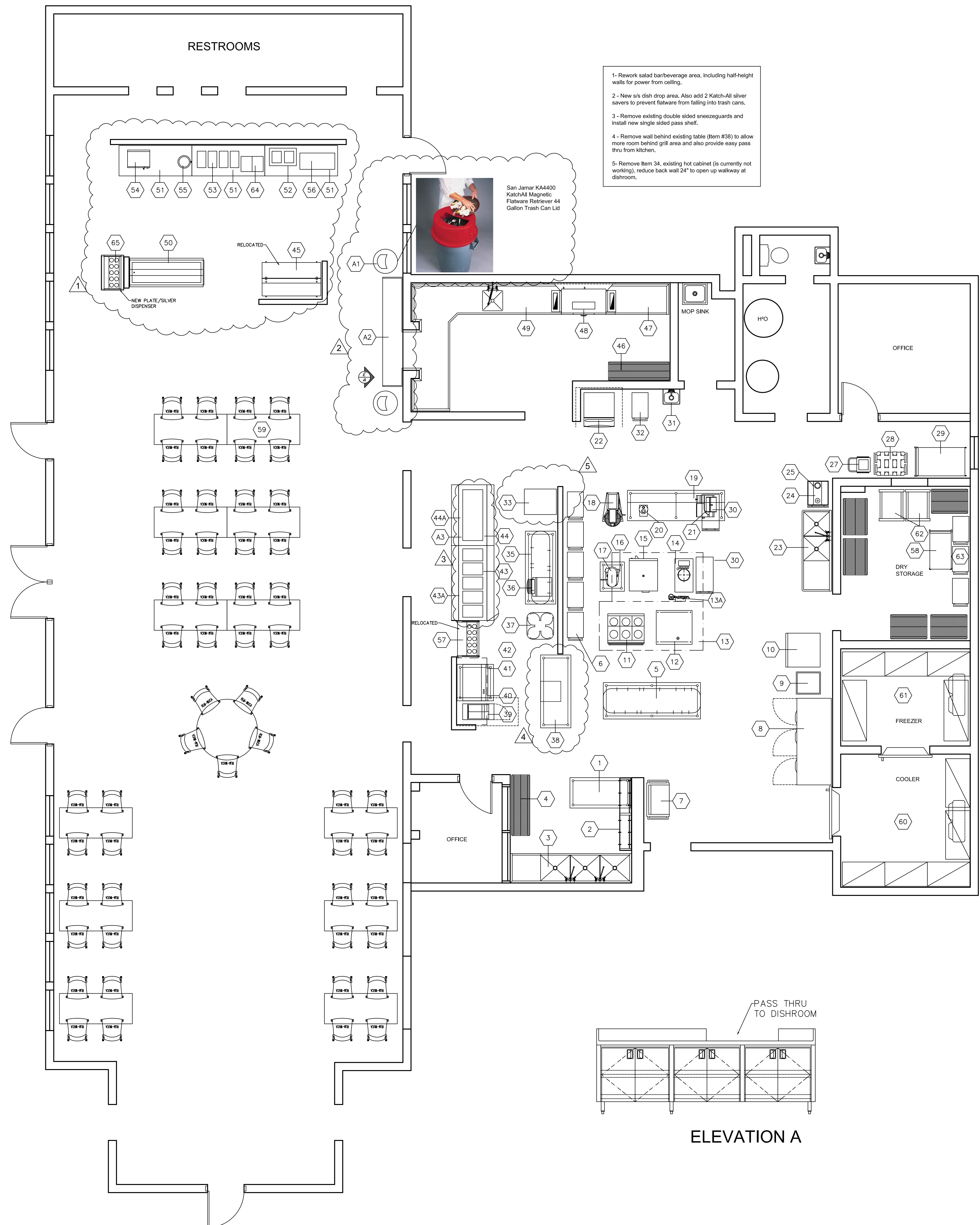

ELEVATION A

EQUIPMENT SCHEDULE

Item No	Qty	Manufacturer	Model Number	Equipment Category	Equipment Remarks	Volts	Amps
1	1	CUSTOM		30" x 60" S/S WORKTABLE W/UNDERSHELF			
2	1	CUSTOM		72" WALLMOUNTED DOUBLE POTRACK			
3	1	CUSTOM		3 COMPARTMENT SINK			
4	1	InterMetro Industries	5N367K3	Shelving Unit, Starter, Metal, Wire			
5	1	CUSTOM		36" x 96" S/S WORKTABLE W/UNDERSHELF AND POT RACK			
6	7	Cambro	BC225-110	Cart, Bussing			
7	1	Cambro	TDC2029-131	Cart, Dish & Tray			
8	1	Continental Refrigerator	3FE	Freezer, Reach-in		115/208-230	12.1
9	1	CUSTOM		22" X 24" CART			
10	1	Woods	F25NAD	Freezer, Reach-in		115	9.7
11	1	Vulcan-Hart	E36L	Range, Restaurant, Electric		208	76.0
12	1	Vulcan-Hart	VHL2EP	Steamer, Low Pressure			
13	1	CAPTIVE AIRE		CUSTOM S/S ISLAND HOOD			
13A	1	Everpure	EV9797-21	Filter System, Steamer			
14	1	Vulcan-Hart	1T2018D	Kettle, Steam Jacketed			
15	1	Moffat	E32MS/2	Oven, Convection, Electric w/Water Injection		208	28.8
16	1	CUSTOM		24" X 29" S/S MIXER STAND		208	28.8
17	1	Hobart US Foodservice	ES10-E2N1	Mixer, Counter		120	2.9
18	1	Univex	SRM30	Mixer, Floor		120	13.6
19	1	CUSTOM		30" x 96" S/S WORKTABLE W/OPEN BASE AND OVERSHELF			
20	1	Robot Coupe	R100	Cutter/Mixer, Vertical		120	7.0
21	1	Berkel	827A	Slicer, Food		115	2.5
22	1	Manitowoc Ice	SD-0502A /B-570	Ice Maker w/ Bin		115	13.0
23	1	CUSTOM		2 COMPARTMENT SINK			
24	1	Bunn-O-Matic	04275.0031	Coffee Maker, Pourover		120	13.9
25	1	EXISTING		BUSSING CART			
27	1	Gold Medal		Papcorn Cart			
28	1	Cambro	DC700-192	Cart, Dish & Tray			
29	1	EXISTING		TRANSPORT CART			
30	2	EXISTING		BUSSING CART			
31	1	EXISTING		Sink, Hand, Wall Mount			
32	1	EXISTING		BUSSING CART			
33	1	InterMetro Industries	C175-CVN	Cabinet, Holding/Proofing		120	16.0
35	1	CUSTOM		36" x 72" S/S WORKTABLE W/UNDERSHELF AND POT RACK			
36	1	Star Manufacturing	QCS3-950H	Toaster, Conveyor		208	15.9
37	1	InterMetro Industries	PCD11	Dolly, Dishrack			
38	1	CUSTOM		36" x 72" S/S WORKTABLE W/UNDERSHELF AND DRAWER			
39	1	Frymaster	RE14-2	Fryer Battery, Deep Fat, Electric		208	39.0
40	1	APW Wyatt	EG-36H	Griddle, Electric		208	48.7
41	1	CUSTOM		36" x 36" S/S EQUIPMENT STAND			
42	1	CAPTIVE AIRE		CUSTOM S/S EXHAUST HOOD			
43	1	Vollrath	37050	Buffet/Cafeteria, Hot Food-Soup Station		120	
43A	1	Vollrath	36303	Buffet/Cafeteria, Buffet Shield			
44	1	Vollrath	36160	Buffet/Cafeteria, Cold Food Station			
44A	1	Vollrath	36302	Buffet/Cafeteria, Buffet Shield			
45	1	Continental Refrigerator	MC5-S	Milk Cooler		115	
46	1	InterMetro Industries	5N367K3	Shelving Unit, Starter, Metal, Wire			
47	1	CUSTOM		30" x 62" CLEAN DISHTABLE			
48	1	CMA Dishmachines	CMA-44H/L-R	Washer, Rack Conveyor		208	31.0
49	1	CUSTOM		30" x 62" CLEAN DISHTABLE			
50	1	Duke Manufacturing	AHC-5M	Buffet/Cafeteria, Cold Food Station		120	5.2
51	3	EXISTING		30" x 72" FOLDING TABLE			
52	1	EXISTING		CEREAL DISPENSER			
53	4	EXISTING		CONDIMENT DISPENSER			
54	1	EXISTING		Oven, Microwave		120	15.0
55	1	APW Wyatt	RCW-11	Cooker/Warmer		120	10.0
56	1	SILVER KING	SKMAJ2	MILK DISPENSER		120	10.0
57	1	Lakeside	403	Cart, Tray & Silver			
58	1	Lakeside	444	Cart, Tray Transport, Open			
59	12	EXISTING		30" x 72" DINING TABLE			
60	1	CUSTOM		WALK-IN COOLER			
61	1	CUSTOM		WALK-IN FREEZER			
62	2	EXISTING		Rack, Utility			
63	1	EXISTING		BUSSING CART			
64	1	EXISTING		JUICE DISPENSER			
65	1	Lakeside	213	Cart, Tray & Silver			
A1	2	San Jamar	KA4400	Katch-All			
A2	1	CUSTOM		20" X 72" CUSTOM S/S TRAY DROP			
A3	1	CUSTOM		CUSTOM S/S PROTECTOR			

EXISTING KITCHEN EQUIPMENT

SCALE: 1/4" = 1'-0"

Orange County
Youth and Family Services
1718 E. Michigan Street
Orlando, FL 32806

REV. NO.	DATE	DESCRIPTION
	06/30/10	

commercial
kitchen
designs

386.216.7646
WINTER SPRINGS, FL
www.commercialkitchendesigns.com

PROPOSED
KITCHEN

SHEET FS-2